

dimension 2.400 mq
 project 2015-16
 completed 2016

port museum trieste



descrizione

concept design and detailed proposal
 renovation and installation design of the outdoor
 areas

client

Trieste Port Authority

The project involves the redesigning of the external spaces between the between the Hydrodynamic Power Plant and the Electric Substation in the Trieste Old Harbour to complete a new identity for the museum area, characterizing it with a clear vocation of public space and openness to the city.

This area will become a walk dedicated to the Polo Museale del Porto di Trieste, by the creation of an installation composed of bollards and a metal ring with an external diameter of approx. 3.50 m will find an adequate position in the ground with an inlay of letters that make up a sort of memory path, through the re-proposition of embarkation calls and the main routes influenced by commercial traffic in the Old Port of the city of Trieste.

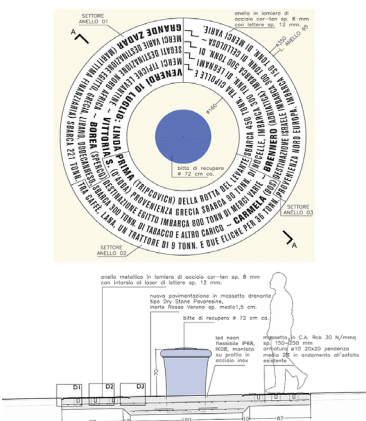

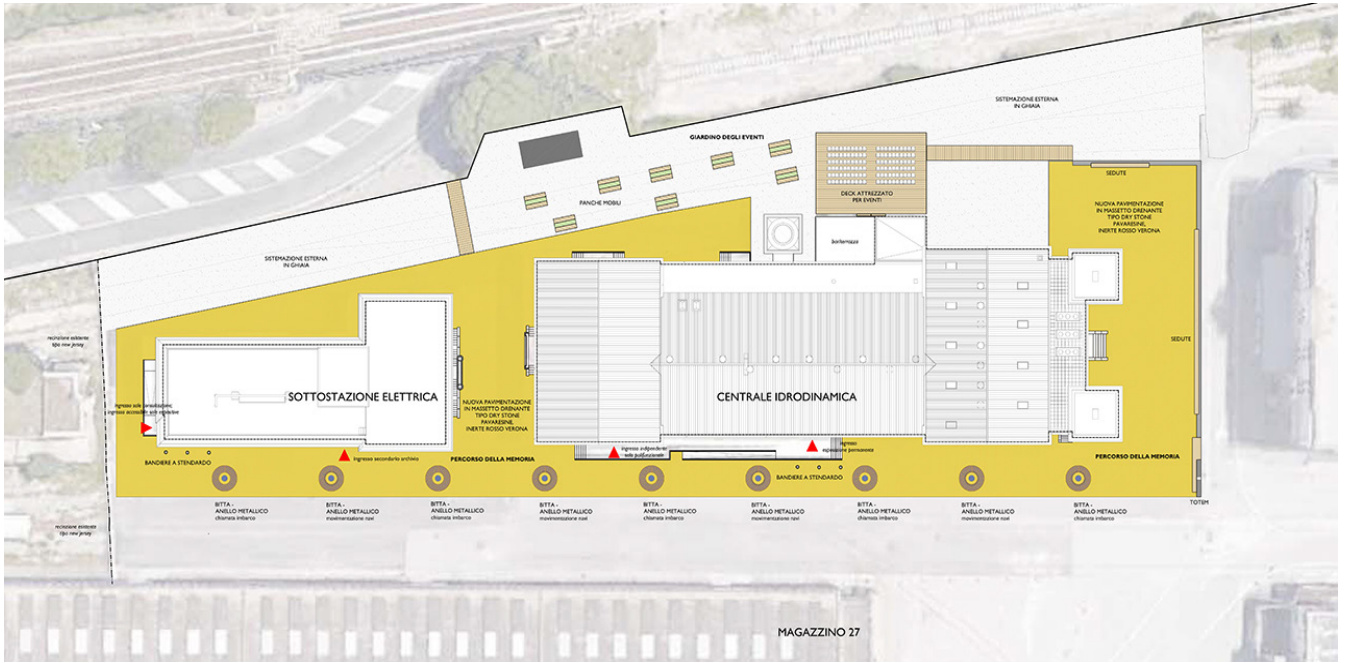

MAGAZZINO 27

